

# 5GEB20

## Vertical Mount AC Drilling Motor 1150 HP (858kW)



### Performance ratings

The 5GEB20 AC drilling motor with 2800 SCFM airflow and temperature rise of 110°C at 45°C ambient.



	<b>Continuous Rating</b>	<b>Intermittent Rating</b>
Volts (ac)	600/690	600/690
Current	1120	1380
HP (kW)	1150 (858)	1400 (1044)
Speed @ rated HP	800 to 1800	800 to 1600 RPM
Torque – lb <sub>r</sub> -ft (Nm)	7550 (10240)	9200 (12475)
Speed @ rated torque	0 to 800	0 to 800 RPM
Max speed - 2300 RPM		

GE has more than 50 years of experience in the drilling industry, a worldwide service network, thousands of AC/DC drilling motors in service today – built to match the most rugged drilling applications on earth.

### Standard features

- Special frame head and thrust bearing for vertical operation
- 6-pole stator with FORM WOUND windings
- Copper chromium alloy rotor bars
- Class H insulation, robotically taped, Mica-Kapton system
- Insulated bearing on non-drive end
- Double shaft extension (Hubs are optional)
- Winding RTDs, 100 ohm platinum; 2 per phase
- Separately ventilated – flanged inlet provided for forced ventilation, blower not included, requires 2800 SCFM during operation
- Three 16 ft. power leads - 646 MCM armored cables
- Connection lugs and terminal box not included
- Dimensionally interchangeable with the GE752
- Space Heater – 400 watts (200 watts per each end of motor)

### Optional features:

- ATEX certified Ex e II T3,  II 2 G c T3
-  Mark
- ABS and/or DNV certification
- ABS certified shaft
- IP44 blower assembly (same as 5GEB22)
- IP56 connection box for remote mounting
- IP44 air outlet duct assembly (same as 5GEB22)
- Hubs



imagination at work

Calculated by  
GEMCM

**GEB20/22 Performance Curves**  
Rated & 150% Overload (Intermittent Short-Time Capability)

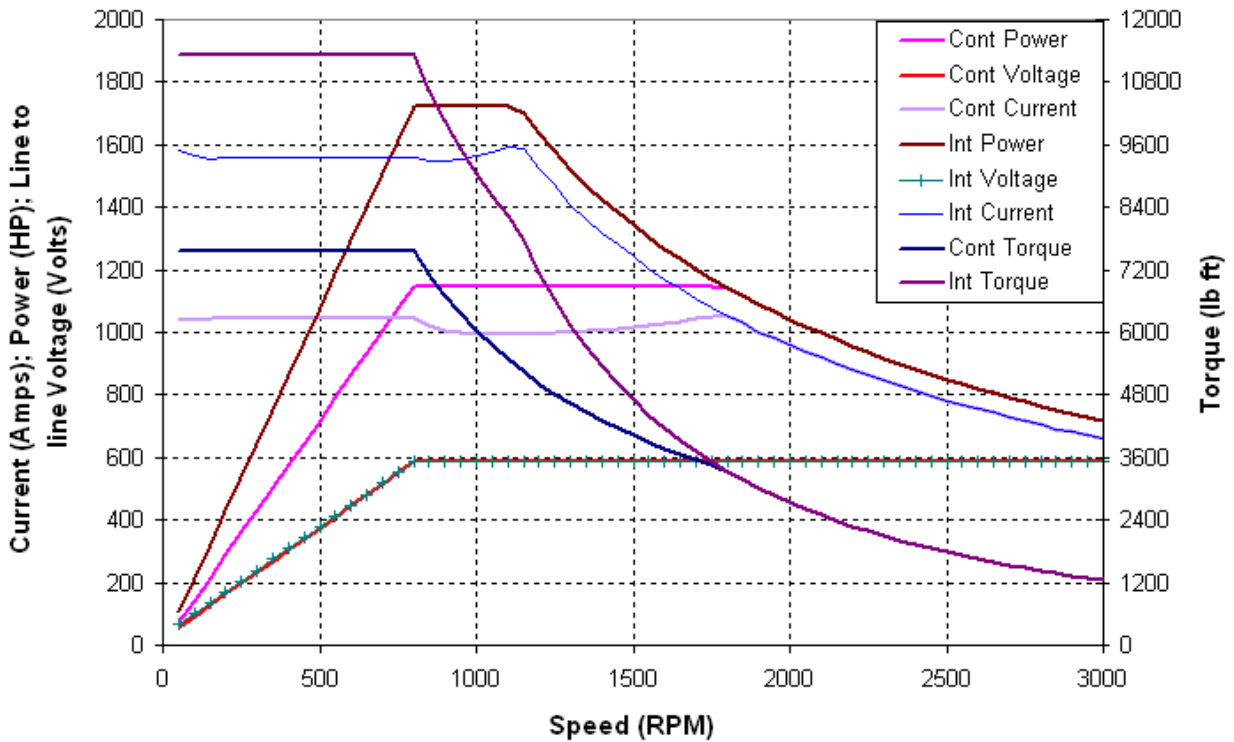

Approximate weight: 6200 lbs. (2812 kg.)

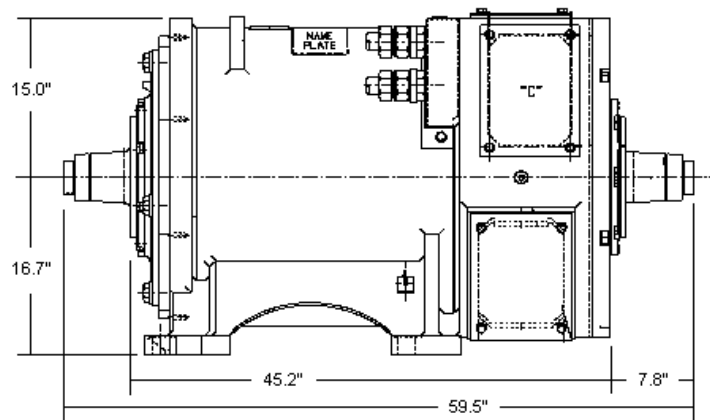
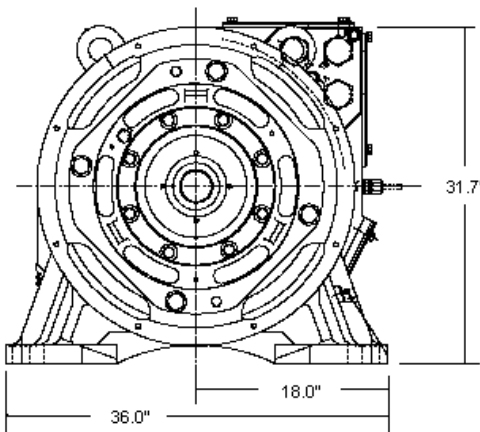

imagination at work

To find out more fax inquiries to 832-295-7600  
or visit us online at [www.getransportation.com](http://www.getransportation.com)